



IRTReels

Owner's Manual

Innovative Reel Technologies
Spinning Series 300, 400, & 500



Thank you for your purchase...

Innovative Reel Technologies, Ltd. began as a dream to create the most durable, high performance, aluminum-machined fishing reel available. The goal included creating a reel for sport fishermen to last a lifetime and hand down to the next generation of fishing enthusiasts. Greg Header, our president, chose to team up with one of the most talented aluminum fishing reel designers in the country, Tim Wiest, who has 20 years of experience. Together, they are redefining the standard reel design with innovative concepts and superior craftsmanship from the small Central Appalachian town of Pine Grove, PA. These spinning reels have been in development for over six years and are the result of an immense investment of time and hard work, which produced the durable reels complete with all of the custom options desired by the most dedicated fishermen.

Thanks!

Greg Header, IRT President

External Features

- Anodized, 6000-series aluminum housing produced through a patented method of using a single long bar extrusion



- Patented SPINNING POWER GRIP™ (shown here). An optional innovative fishing reel leg, which provides superior leverage and is exclusively available through Innovative Reel Technologies. The SPINNING POWER GRIP™ is located near the rear of the reel, allowing an angler's fingers to be located in a position they would not normally be capable of when fishing with a traditional reel because of a large reel foot. By placing all the fingers together, with no large reel foot located in-between them, the angler is able to gain greater leverage; all fingers are able to gain a solid grip on the rod. By not having a restrictive reel foot in the middle of the angler's hand, the angler is able to position their hand to create the easiest position to grab line between casts. Additionally, the SPINNING POWER GRIP™ helps prevent blisters from occurring in-between fingers.

- The lengthened lever arm of IRT's aluminum machined fishing reels provides improved casting performance; this allows for lighter lines and lures.
- IRT's aluminum machined spools rotate and adjust with precision to create a symmetrical line wrap, improving casting, drag, and line performance.
- The reversible handle from Innovative Reel Technologies allows for versatility between fellow outdoorsmen or various fishing needs. This unique design gives the fisherman an advantage over the ordinary right and left handed reels that are traditionally offered within the aluminum machined fishing reel industry.
- Front drag knob for precise control over wide drag range that tops out at a powerful maximum.
- All reels come with a protective carrying/storage case. Accessories include rod/reel lubricant, reel grease, and an IRT microfiber cloth for maintenance.
- Interchangeable colors and parts specific to IRT make high quality aluminum machined fishing reel replacement parts available to our customers long after the initial purchase at a reasonable rate. Eight standard IRT colors and virtually unlimited color combinations allow the purchaser to create specific custom color reel combinations.
- All IRT Reels feature a reel specific serial number that is unique to that individual reel

Series recommendations

Series	300	400	500	600	700	800
Weight (oz)	15	16	17	25	27	28
Max Drag (lbs)	25	25-30	25-35	40-50	50-60	55-65
Gear Ratio	4.55	4.55	4.55	4.78	4.78	4.78
Line Retrieve (in)	27	30	33	37	40	44
Recommended Mono Line* (yds/lbs)	200/10	280/10	370/10	210/20	200/25	300/25
	180/12	240/12	330/12	165/25	150/40	190/40
	150/15	200/15	290/15	140/30	110/50	140/50
Recommended Braid Line* (yds/lbs)	340/15	350/20	375/30	400/40	390/50	525/50
	300/20	300/30	320/40	370/50	340/65	460/65
	250/30	250/40	300/50	325/65	325/80	425/80

*Please note: Line capacities can vary by line manufacturer, line spool fill, or backing used.



Internal parts

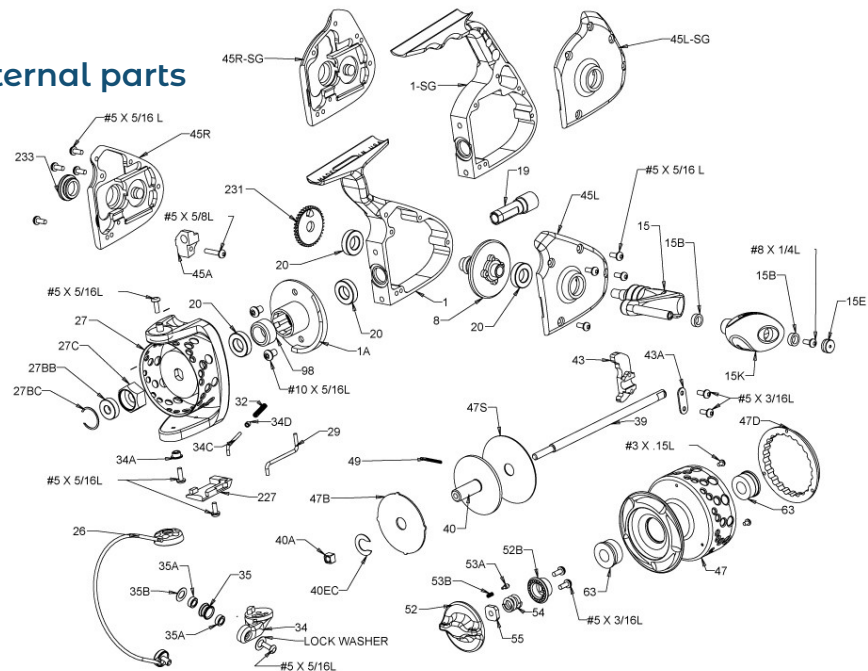

300, 400, and 500 Series Parts List

PART NO.	DESCRIPTION	PART NO.	DESCRIPTION	PART NO.	DESCRIPTION
1	Housing	34C	Bail Spring Arm	47S	Drag Seal
1-SG	Spin Power Grip Housing	34D	Bail Spring Washer	47 Complete	Complete Spool, Holes Includes:
1A	Housing Face	35	Line Roller	47	63 (2)
8	Main Gear Complete	35A	Ball Bearing	47D	#3-15L screw (3)
15	Handle crank	35B	Washer		Assembled
15B	Ball Bearing	43	Crosswind Block		
15E	Handle Knob Cap	39	Spool Shaft	49	Drag Click Spring
15K	Comfort Handle Knob	40	Shaft Sleeve, Drag Washer and Seal	52	Drag Knob
19	Pinion Gear	40A	Shaft Nut	52B	Drag Knob Base
20	Ball Bearing	40EC	Shaft E Clip	53A	Click Pin
26	Bail Wire Complete	43A	Crosswind Block Plate	53B	Click Pin Spring
27	IRT Standard Rotor	45L	Left Side Plate	54	Drag Spring
27c	Rotor Nut	45R	Right Side Plate	55	Drag Nut
27BB	Ball Bearing	45L-SG	Spin Power Grip Left Side Plate	63	Spool Bearing
27BC	Ball Bearing Clip	45R-SG	Spin Power Grip Right Side Plate	98	Anti Reverse Clutch and Sleeve
29	Trip Bar	45A	Shaft Support	227	Rotor Cover
32	Bail Spring	47	Spool	231	Crosswind Gear
34	Bail Arm	47B	Fiber Drag Washer	233	Cover cap
34A	Bail Arm Washer	47D	Spool Ring		

Ordering Parts

IRT requires the model number, part number, and description of the replacement part that you wish to order. This will help us provide the right part for you.

Reversible Handle

Your IRT reel comes with a reversible handle to customize your preference or to adjust for another user. If you use your left hand to reel, the handle will thread counterclockwise to tighten and clockwise to loosen. If you use your right hand to reel, then the handle will thread clockwise to tighten and counterclockwise to loosen. Once you have your handle fixed on your preferred side, place the cover cap on the opposite side.

IRT Reels are protected by the following patents:

US D560,267 S, US 7,886,588 B2

Contact us

Integrated Reel Technologies Inc.
31 Roberts Road
Pine Grove, PA 17963

Phone: 1-877-812-4843

Email: reels@irtreels.com

IRT apparel
<https://irtreels.com>



Care and Maintenance

IRT Reels proudly offers fishing reel maintenance and repair services to customers. IRT suggests that customers complete regular maintenance of their reels. Frequency will be determined by overall use and standard wear and tear on the reel. If the reel is used primarily for saltwater fishing, additional maintenance may be required to maintain product appearance and function. Immediately upon return from a salt water fishing trip, IRT reels should be cleaned in warm soapy water. A light film of IRT oil, provided with each reel should be applied to all exterior surfaces and moving parts to ensure proper function. Reels should be dried thoroughly after each use. Reels should be stored in the supplied case, but must be dried before they are stored. Annual service, completed by the IRT team is also recommended. Please visit Why Choose IRT? on our website for additional information on our service capabilities.

Product Registration

Your IRT is automatically registered for warranty if you purchase directly from IRT. If you purchased through one of IRT's dealers, you must register your reel. Please contact IRT using the information above. You will be required to mail, email, or fax a copy of the dated sales receipt. Your warranty will begin at the date of the sale.

Lifetime Limited Warranty

Innovative Reel Technologies (IRT®) 300, 400, 500, 600, 700, & 800 series spinning reels are warranted for a period of one (1) year from the date of original retail purchase against defects in workmanship and/or materials. This warranty is offered to the original purchaser only. In addition, IRT® offers a limited lifetime warranty for spinning reels that are serviced annually by either IRT® or a certified IRT® dealer. Original purchaser must return their reel for service annually to continue the limited lifetime warranty. Failure to do so will result in expiration of the warranty. Services costs range from \$39.95 to \$69.95 depending on reel type, plus prepaid postage both ways. There will be a two week grace period from a year after the date of purchase to send in your reel for servicing.

IRT® reserves the right to make all decisions, at its sole discretion, regarding whether a claim qualifies as eligible warranty work. During the warranty period (1 year), IRT® will repair or replace the product, at its discretion, at no charge to the original purchaser. A dated sales receipt or other dated proof of purchase must accompany all warranty claims. The product should be shipped directly to IRT® at 31 Roberts Road, Pine Grove, PA 17963, postage prepaid and insured. Package should include the reel being sent for work, the dated proof of purchase/receipt, and all accessories/parts necessary for the functioning reel.

This warranty does not cover reels damaged due to abuse, misuse, corrosion, normal wear and tear (defined as parts designed to act as "maintenance" parts including but not limited to the drag friction disc, etc), excessive wear caused by neglect of normal cleaning and lubrication or an owner(s) failure to provide reasonable and necessary maintenance, or products that have been altered or modified by a person or company that is not at IRT® or a certified IRT® dealer.

IRT® products not covered by this IRT® Limited Warranty may be repaired at a nominal charge to the purchaser, provided parts are available and the product is shipped to IRT® with return postage prepaid.

Repair parts or colors may not be a direct match to the original in-service parts due to the natural aging process of colorants used in the manufacturing process and variations in batch coloration.

The remedies described herein shall be the sole and exclusive remedies available to the purchaser. Correction of defects, in the manner and time period described herein, shall constitute complete fulfillment of all liabilities and responsibilities of IRT® to the purchaser with regard to this product. IRT® shall not be liable or in any way responsible for repairs or attempted repairs performed by anyone other than an authorized service provider. IRT® IS NOT LIABLE, OR IN ANY WAY RESPONSIBLE, FOR ANY INCIDENTAL OR CONSEQUENTIAL DAMAGE OF ANY KIND. Implied warranties of merchantability and fitness for a particular purpose are excluded.

The provisions of this warranty are in addition to statutory warranties and other rights and remedies contained in any applicable legislation. To the extent that any provision of this warranty is inconsistent with any applicable law, such provision shall be deemed voided or amended, as necessary, to comply with such law.



